

PROPRIETARY AND CONFIDENTIAL

THE INFORMATION CONTAINED IN THIS DRAWING IS THE SOLE PROPERTY OF DYTRAN INSTRUMENTS INC. ANY REPRODUCTION IN PART OR AS A WHOLE WITHOUT THE WRITTEN PERMISSION OF DYTRAN INSTRUMENTS INC. IS PROHIBITED

MODEL	RANGE
7700A1	±5G
7700A2	±10G
7700A3	±25G
7700A4	±50G
7700A5	±100G
7700A6	±200G

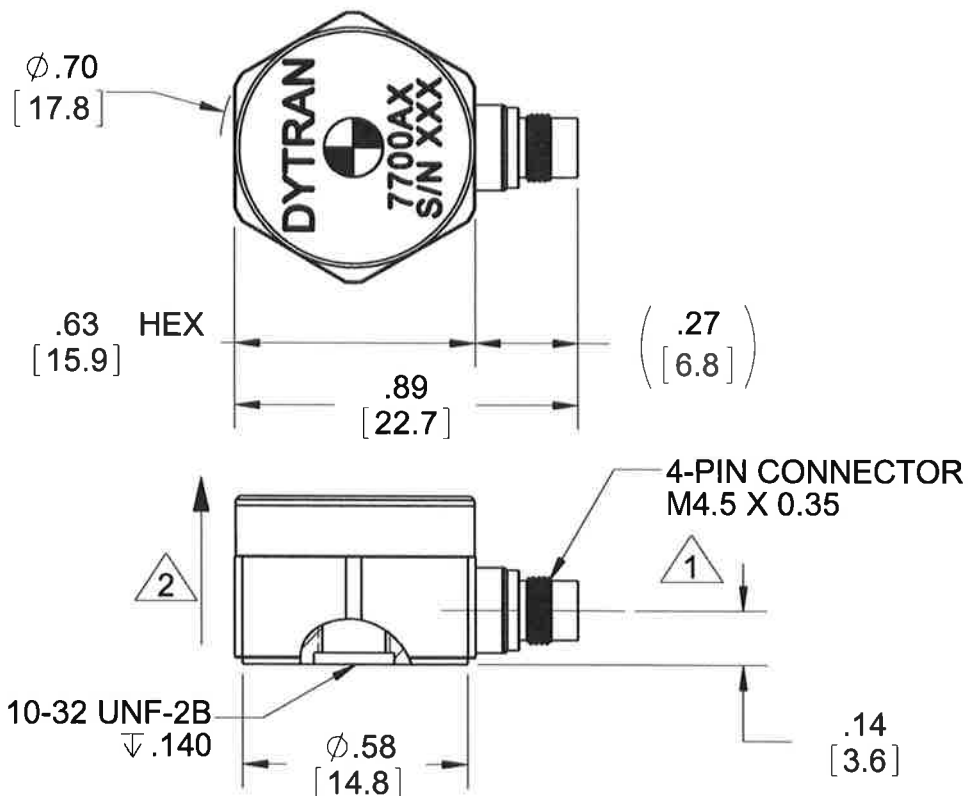
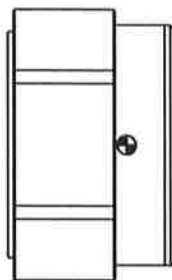

6. WEIGHT: 8 GRAMS MAX
5. OPERATING TEMPERATURE RANGE: -40 TO 248 °F [-40 TO 120°C]
4. HOUSING/CONNECTOR MATERIAL: TITANIUM ALLOY
- 3 MOUNT USING DYTRAN 6200 MODEL (SUPPLIED)
- 2 ARROW INDICATES DIRECTION OF ACCELERATION FOR POSITIVE OUTPUT
- 1 MATES WITH DYTRAN 6895AXX CABLE (XX = LENGTH IN FEET)

NOTES: UNLESS OTHERWISE SPECIFIED

UNLESS OTHERWISE SPECIFIED: INTERPRET DIM & TOL PER ASME Y14.5M - 1994. REMOVE BURRS. COUNTERSINK INTERNAL THDS 90° TO MAJOR DIA. CHAM EXT THDS 45° TO MINOR DIA. THD LENGTHS AND DEPTHS ARE FOR MIN FULL THDS. THDS PER MIL-S-7742. DIMENSIONS APPLY AFTER FINISHING.	
USED ON	NEXT ASSY
APPLICATION	
THIRD ANGLE PROJECTION USA	
ALL MACHINED SURFACES. TOTAL RUNOUT WITHIN .005. BREAK SHARP EDGES .005 TO .010. MACHINED FILLET RADII .005 TO .015. WELDING SYMBOLS PER AWS A2.4. ABBREVIATIONS PER MIL-STD-12.	

UNLESS OTHERWISE SPECIFIED: DIMENSIONS ARE IN INCHES. DIMENSIONS IN BRACKETS [] ARE IN MILLIMETERS TOLERANCES ARE:		
INCHES	METRIC	ANGLES
.XX ± .03	.X ± 0.8	± 1°
.XXX ± .010	.XX ± 0.25	
MATERIAL		
FINISH		
DO NOT SCALE DRAWING		

CONTRACT NO.

APPROVALS		DATE
ORIG	DV	02/23/11
CHK	LN	08/14/12
APP	DV	08/21/12
APP	DV	3/30/14

 DYTRAN INSTRUMENTS, INC.		Chatsworth, CA	MASTER ONLY IF IN RED	
TITLE: OUTLINE/INSTALLATION DRAWING, 7700 SERIES				
SIZE A	CAGE CODE 2W033	DWG. NO. 127-7700A	REV D	
SCALE: NONE		SOLIDWORKS		SHEET 1 OF 2

PROPRIETARY AND CONFIDENTIAL

THE INFORMATION CONTAINED IN THIS DRAWING IS THE SOLE PROPERTY OF DYTRAN INSTRUMENTS INC. ANY REPRODUCTION IN PART OR AS A WHOLE WITHOUT THE WRITTEN PERMISSION OF DYTRAN INSTRUMENTS INC. IS PROHIBITED

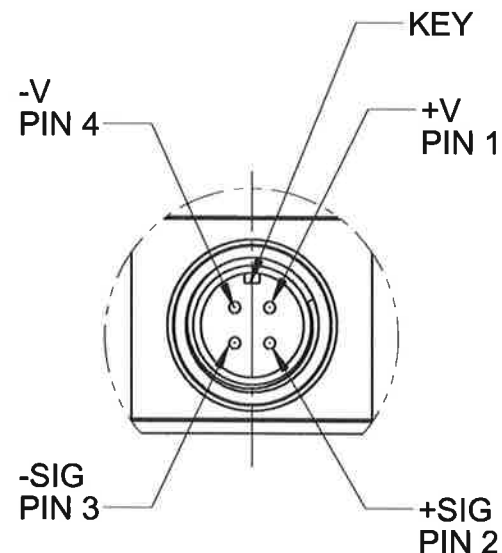
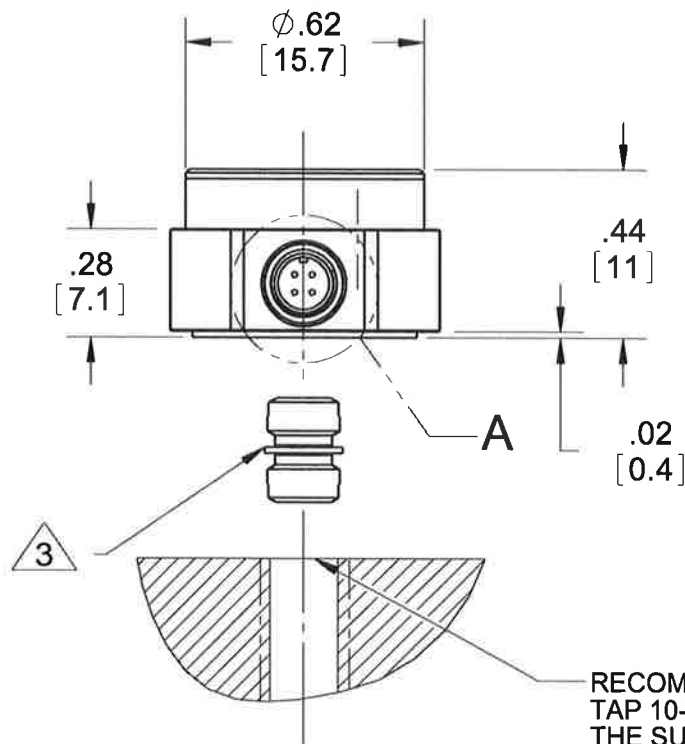

DETAIL A
SCALE 4 : 1

RECOMMENDED MOUNTING PREPARATION:
TAP 10-32 UNF-2B X.160 MIN DEEP. ASSURE
THE SURFACE FLATNESS BETTER THAN
.001 TIR. MOUNTING TORQUE: 6-8 LB-IN.

<p>UNLESS OTHERWISE SPECIFIED: INTERPRET DIM & TOL PER ASME Y14.5M - 1994. REMOVE BURRS. COUNTERSINK INTERNAL THDS 90° TO MAJOR DIA. CHAM EXT THDS 45° TO MINOR DIA. THD LENGTHS AND DEPTHS ARE FOR MIN FULL THDS. THDS PER MIL-S-7742. DIMENSIONS APPLY AFTER FINISHING.</p>		<p>UNLESS OTHERWISE SPECIFIED: DIMENSIONS ARE IN INCHES. DIMENSIONS IN BRACKETS [] ARE IN MILLIMETERS TOLERANCES ARE: INCHES METRIC ANGLES .XX ± .03 .X ± 0.8 ± 1° .XXX ± .010 .XX ± 0.25</p>		<p>CONTRACT NO.</p>		<p>DYTRAN INSTRUMENTS, INC. MASTER Chatsworth, CA ONLY IF IN RED</p>	
USED ON	NEXT ASSY	<p>APPROVALS</p>		<p>DATE</p>		<p>TITLE: OUTLINE/INSTALLATION DRAWING, 7700 SERIES</p>	
<p>APPLICATION THIRD ANGLE PROJECTION USA</p>		<p>MATERIAL</p>		<p>ORIG</p>	<p>DV</p>	<p>02/23/11</p>	<p>SIZE A</p>
<p>ALL MACHINED SURFACES. TOTAL RUNOUT WITHIN .005. BREAK SHARP EDGES .005 TO .010. MACHINED FILLET RADII .005 TO .015. WELDING SYMBOLS PER AWS A2.4. ABBREVIATIONS PER MIL-STD-12.</p>		<p>FINISH</p>		<p>CHK</p>	<p>LN</p>	<p>08/14/12</p>	<p>CAGE CODE 2W033</p>
<p>DO NOT SCALE DRAWING</p>		<p>APP</p>		<p>APP</p>	<p>DV</p>	<p>08/21/12</p>	<p>DWG. NO. 127-7700A</p>
				<p>SCALE: NONE</p>		<p>SOLIDWORKS</p>	
				<p>SHEET 2 OF 2</p>		<p>REV D</p>	

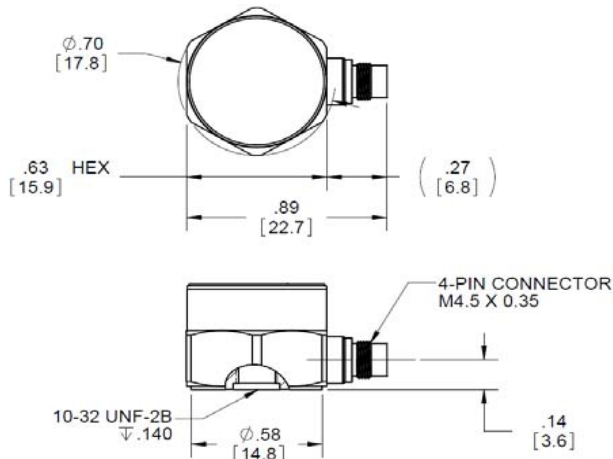
Model Number 7700A1		PERFORMANCE SPECIFICATION				DOC NO PS7700A1	
		VARIABLE CAPACITANCE ACCELEROMETER				REV E, ECN 15839, 07/28/20	
		<ul style="list-style-type: none">• POWER SUPPLY IDENTICAL TO STRAIN GAGE SENSORS• VARIABLE CAPACITANCE ACCELEROMETER• DIFFERENTIAL MODE• HERMETICALLY SEALED• DC RESPONSE					
		ENGLISH				SI	
PHYSICAL							
Weight, Max		0.28	oz	8.0	grams		
Connector	Type	4-PIN, M4.5 x 0.35 THD		4-PIN, M4.5 x 0.35 THD			
Mounting	Tapped Hole	10-32 UNF-2B		10-32 UNF-2B			
Material		Ti-6Al-4V		Ti-6Al-4V			
PERFORMANCE							
Input Range		±5	g pk	±49	m/s ² pk		
Frequency Response	(±5%)	0-200	Hz	0-200	Hz		
	(±3dB)	0-500	Hz	0-500	Hz		
Sensitivity Differential, ±5% [1]		100	mV/g	10.2	mV/m/s ²		
Output Noise, Differential, Typ		12	µg RMS/√Hz	118	µm/s ² RMS/√Hz		
Non-Linearity, Max [2]		0.5	% F.S	0.5	% F.S		
Sensitivity Change with Excitation Voltage (6-22 Volts)		0.3	%	0.3	%		
Cross Axis Sensitivity		< 3	%	< 3	%		
ENVIRONMENTAL							
Maximum Mechanical Shock (0.1 ms)		±2000	g pk	±19620	m/s ² pk		
Bias Temperature Shift, Max [3]		111	(ppm of span)/°F	200	(ppm of span)/°C		
Sensitivity Temperature Shift		-139 to +139	ppm/°F	-250 to +250	ppm/°C		
Operating Temperature Range		-67 to 257	°F	-55 to 125	°C		
Seal		Hermetic		Hermetic			
ELECTRICAL							
Output Common Mode Voltage ± VDC		[4]		[4]			
Output Impedence, Nom		1225	Ω	1225	Ω		
Operating Voltage		±3 to ±11	VDC	±3 to ±11	VDC		
Operating Current, Max		13	mA Dc	13	mA Dc		
Change in Operating Current to Excitation Voltage		0.25	mA/V	0.25	mA/V		
Electrical Isolation (Case)		> 100	MΩ	> 100	MΩ		
		This family also includes:					
Model	Input Range (g pk)	Frequency response (Hz) +/-3dB	Sensitivity Differential, ±5% (mV/g)	Max.Shock (0.1ms)	Noise Differential (µg RMS/√Hz)		
7700A2	±10	0-1000	50	5000	18		
7700A3	±25	0-1400	20	5000	25		
7700A4	±50	0-2000	10	5000	50		
7700A5	±100	0-2500	5	5000	100		
7700A6	±200	0-3000	2.5	5000	200		
		Refer to the performance specifications of the products in this family for detailed description					
		Supplied Accessories:					
		1) Accredited calibration certificate (ISO 17025)					
		2) Mounting stud model # 6200					
		Notes:					
		[1] Single ended sensitivity is half of values shown					
		[2] -90% to +90% of Full Scale					
		[3] Over the rated temperature range					
		[4] Bias voltage equal to (+ v - (-v)) / 2					
		[5] Mating cable 6895A					
		[6] In the interest of constant product improvement, we reserve the right to change specifications without notice.					
		It is the customer's responsibility to validate that a particular product with the properties described in the product specification is suitable for use in a particular application. Parameters provided in datasheets and / or specifications may vary in different applications and performance may vary overtime. All operating parameters, including typical parameters, must be validated for each customer application by the customer's technical experts.					
							
		Units on the line drawing are in inches. Refer to 127-7700A for more information.					



21592 Marilla Street, Chatsworth, California 91311 Phone: 818.700.7818 Fax:818.698.0362 www.dytran.com

For permission to reprint this content, please contact info@dytran.com



21592 Marilla Street, Chatsworth, California 91311 Phone: 818.700.7818 Fax: 818.698.0362 www.dytran.com
 For permission to reprint this content, please contact info@dytran.com